

Handwritten signature and date: 11 Apr 89

SECRET/NOFORN

PROJECT SUN STREAK

WARNING NOTICE: INTELLIGENCE SOURCES AND METHODS INVOLVED

PROJECT NUMBER: ~~SVI TNG~~ 226 SESSION NUMBER: 001
 DATE OF SESSION: 3 Apr 89 DATE OF REPORT: 10 Apr 89
 START: 1115 END: 1210
 METHODOLOGY: CRV VIEWER IDENTIFIER: 032

1. (S/NF/SK) MISSION: Pursue and successfully complete a Stage VI session on a selected site.

2. (S/NF/SK) VIEWER TASKING: Encrypted coordinates 297334/101019 (Bunker Hill Memorial).

3. (S/NF/SK) COMMENTS: Viewer successfully identified dimensional components of site, described many S IV items, and effectively utilized Stage VI time movement tools to report information from late 1700s of direct relevance to meaning and identification of site. ~~Handwritten notes and scribbles~~

Handwritten note: post

4. (S/NF/SK) EVALUATION:

Handwritten marks: 4 and a large scribble

HANDLE VIA SKEET CHANNELS ONLY

SECRET/NOFORN

CLASSIFIED BY: DIA (DT)
DECLASSIFY: OADR

WORKING PAPER

890406

VI 632
04 01

SUMMARY OF INFORMATION

Site is a structure. The structure is made of stone or concrete. The dimensions of the structure are that it rises sharply from relatively flat sides or base supports. The actual construction materials appear to be oversized tan or white brick (see page 80). There is something that rises high and dark behind the structure -- off in the distance.

The structure is somewhat central to it's surroundings. It is used as a rallying point of sorts (SO/S like a library, city hall, theatre), it is something used or seen regularly.

There are ornate aspects to the decoration of the structure (see sketch page 2, day 2). It is older, probably late 1800 to early 1900 in construction. The purpose of the site seems to reflect related to art or remembrance of some event or person in history. The site is meant to preserve the memory of the event or persons.

There were perceptions of war, opposing forces in racing lines or ranks. There were trees, ramparts, emplacements, smoke and haze. I think that the structure is some kind of war memorial.

NO-NOW

032
3 APR 89
1152

congested.

297334
101019

A. sloping up
mound sandy
hard.
B. NOB

297334
101019

A. rising
sharper
sloping down
hard M
B. structure

52

Bree
Blus
Whu
Fough
Sharp
hins
Bumps.

Rough
snake snail
Small
Rough
Shooting
diagonal
curves
square
Small

AI Bank
makes me feel
like I'm in
around some
small structures
all by itself.
lonely.

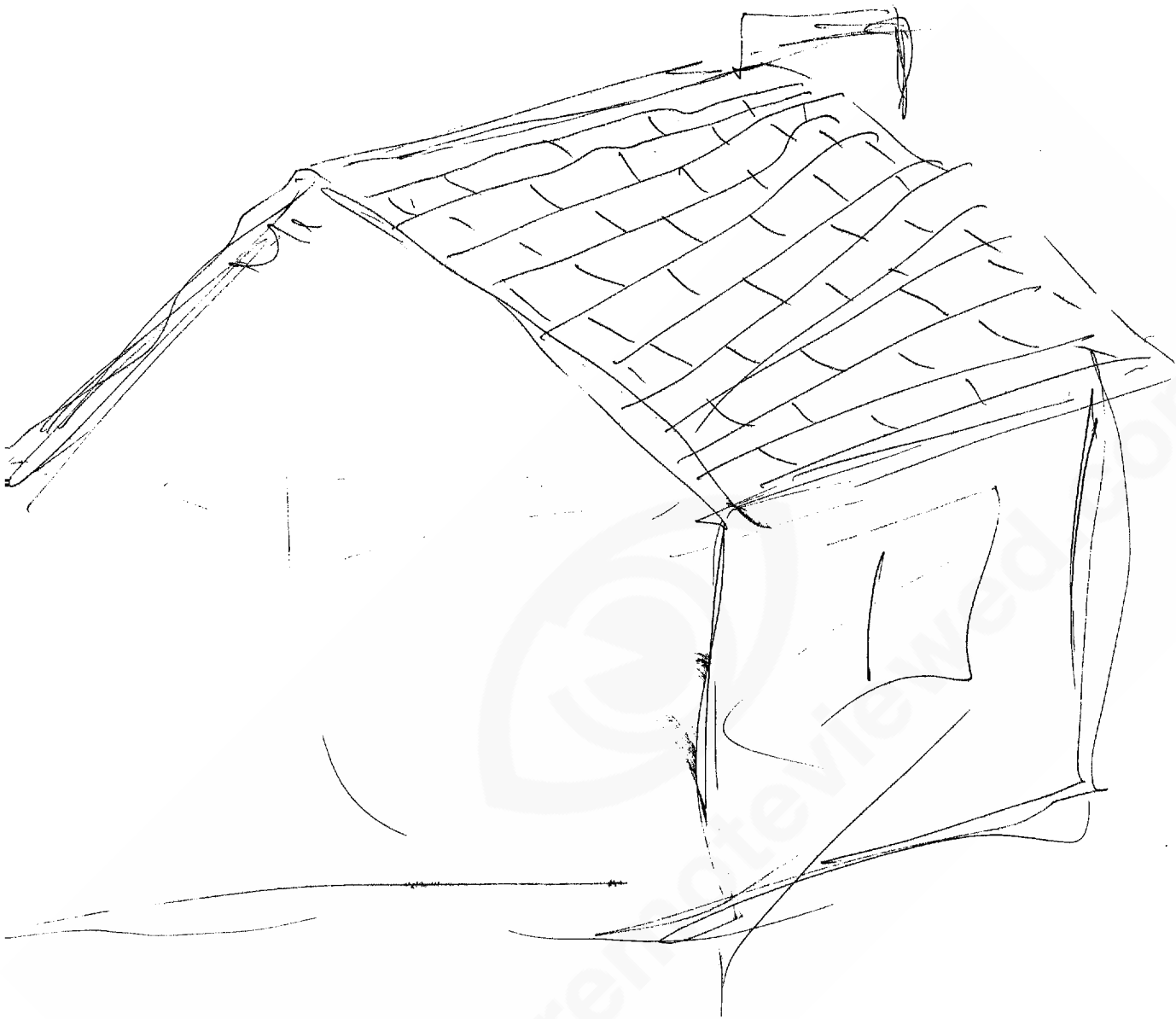

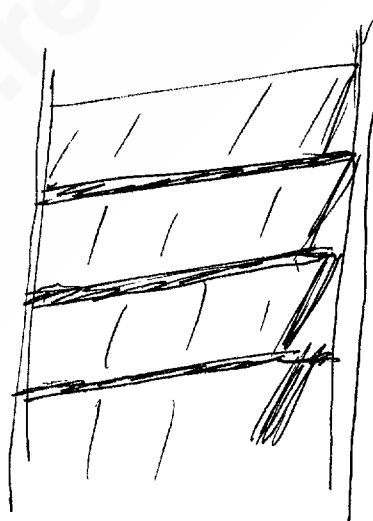
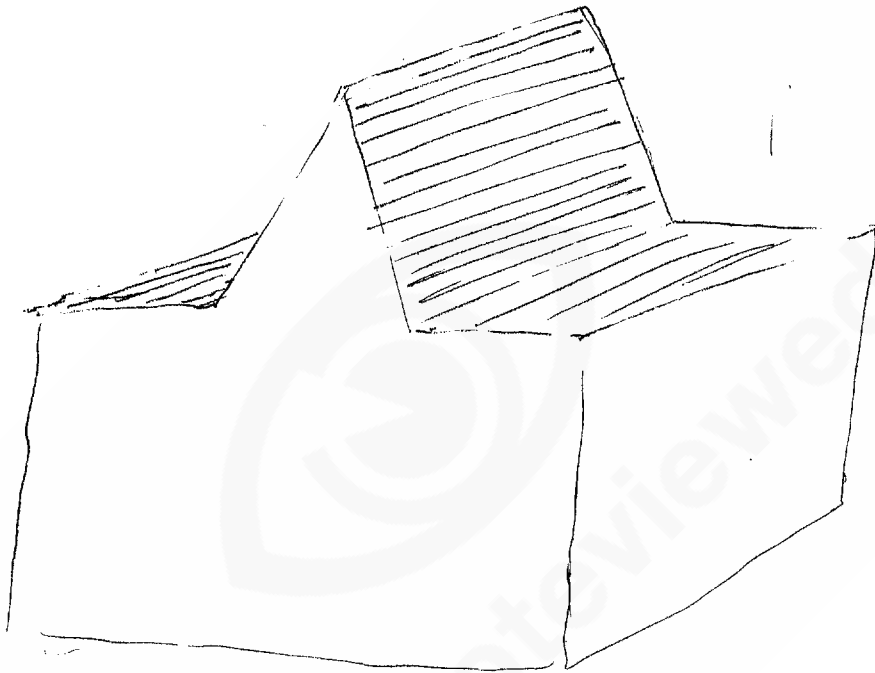

Shiny metallic object
w/ facets or brilliant
implants.

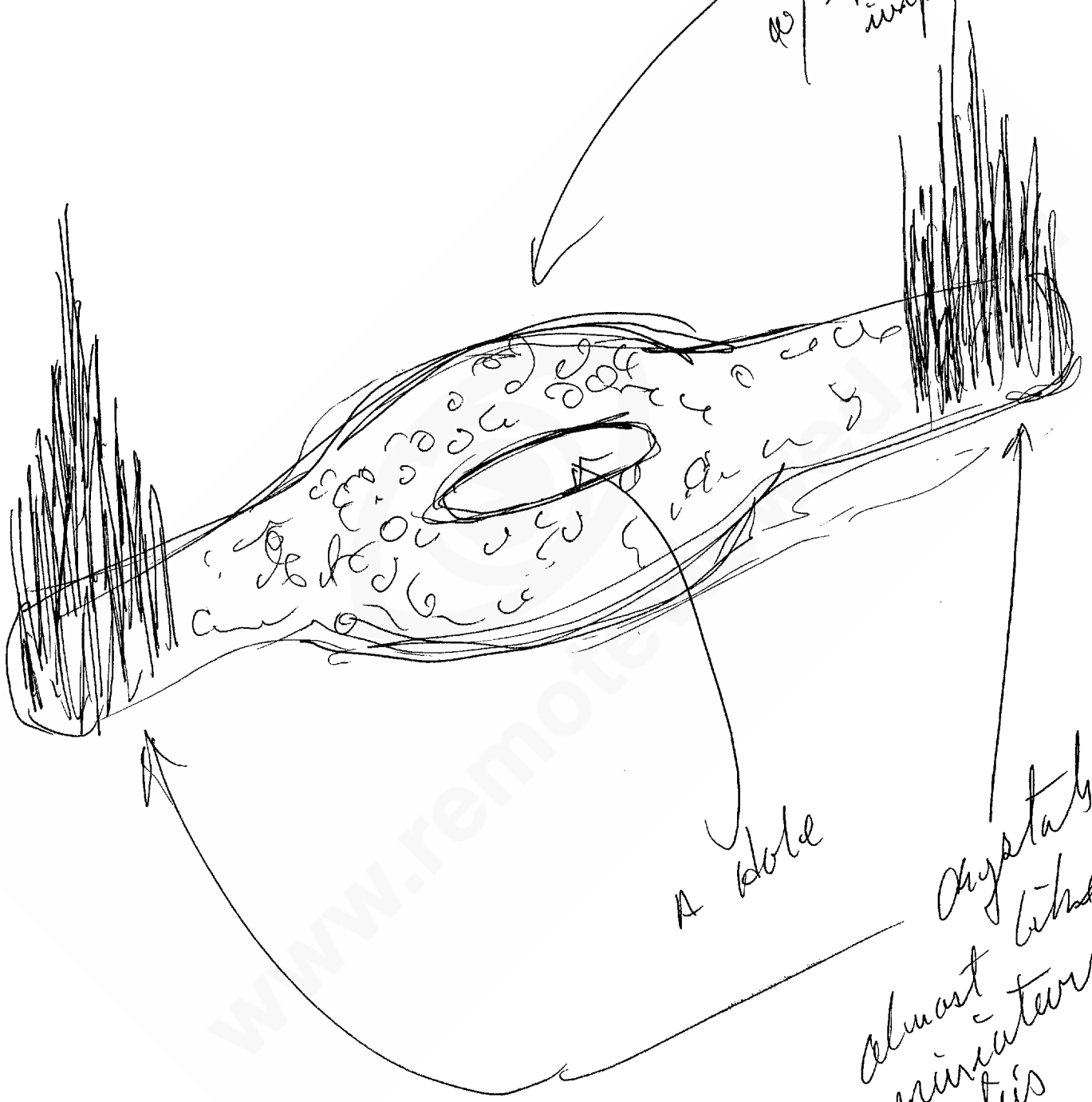

A hole

Crystals
almost like
minerals
art's

52

D

AI

EI

I

I

WOL/n

Rough
Sketch

Tall
 Pentad
 (Dance)
 wide base
 narrow
 protrusions
 peaks
 overhangs
 sloping
 steep
 corners

site Angles inclining into angles - creating
 an mlti. surfaced plane.

outside -
 Inside

Brick
 Wood
 Glass -

No
 Small
 Church.

6.
AD/AS

SZ

D

DI

EL

T

I

hairs
rough

Brown
Red.

glass

grey

metal.

Small

smooth

avers
Banks.

ceramic
coils metal

silica
filament
like coils.

funnel
tubes.

S4 1/2 - I perceive a structure that has
an elongated sloping roof, which
is curved and the length run
from front to back.

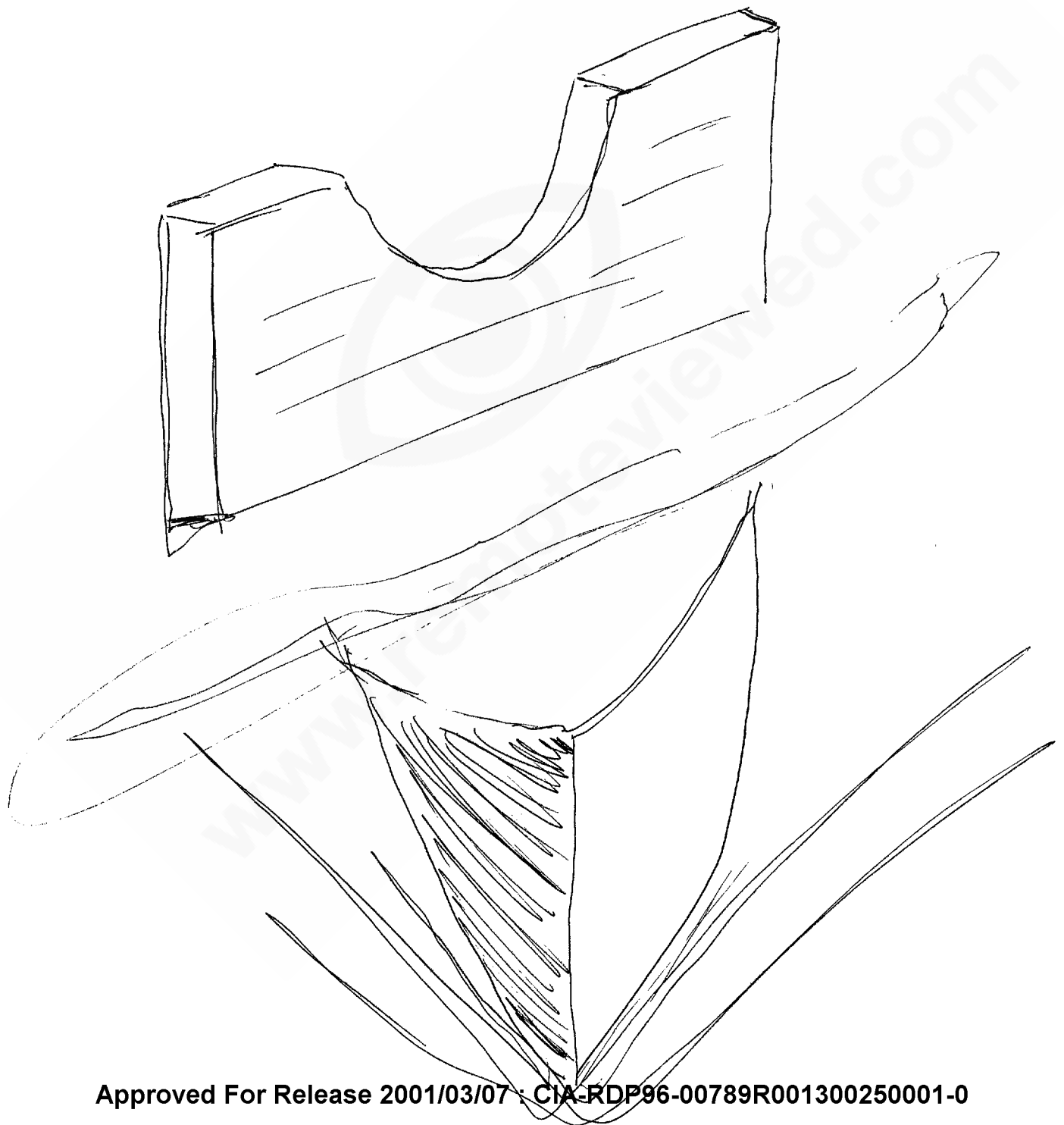

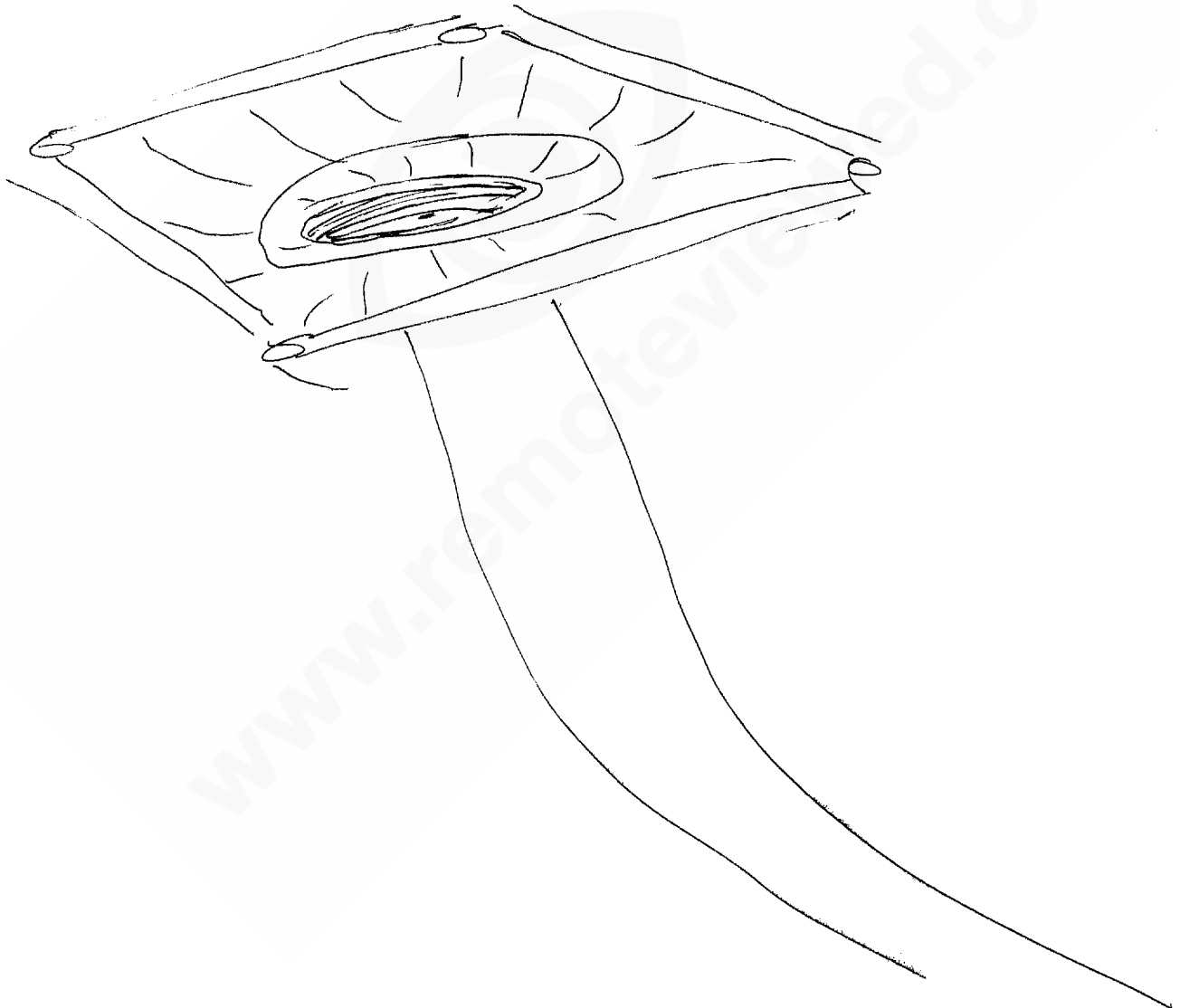

It tapers sharply on both sides and tapers out into flat sides or sections. The structure seems constructed of birch or some natural substance.

st^h something rising high and dark beyond the structure. — behind it mountains.

st^h structure is something central to surroundings — used public meeting place — looks like a town hall like City Hall theater. something used outdoors frequently.

STAGE 6

sz

Approved For Release 2001/03/07 : CIA-RDP96-00789R001300250001-0

I

8 A.
10/15

old,

derb.



www.remoteviewed.com

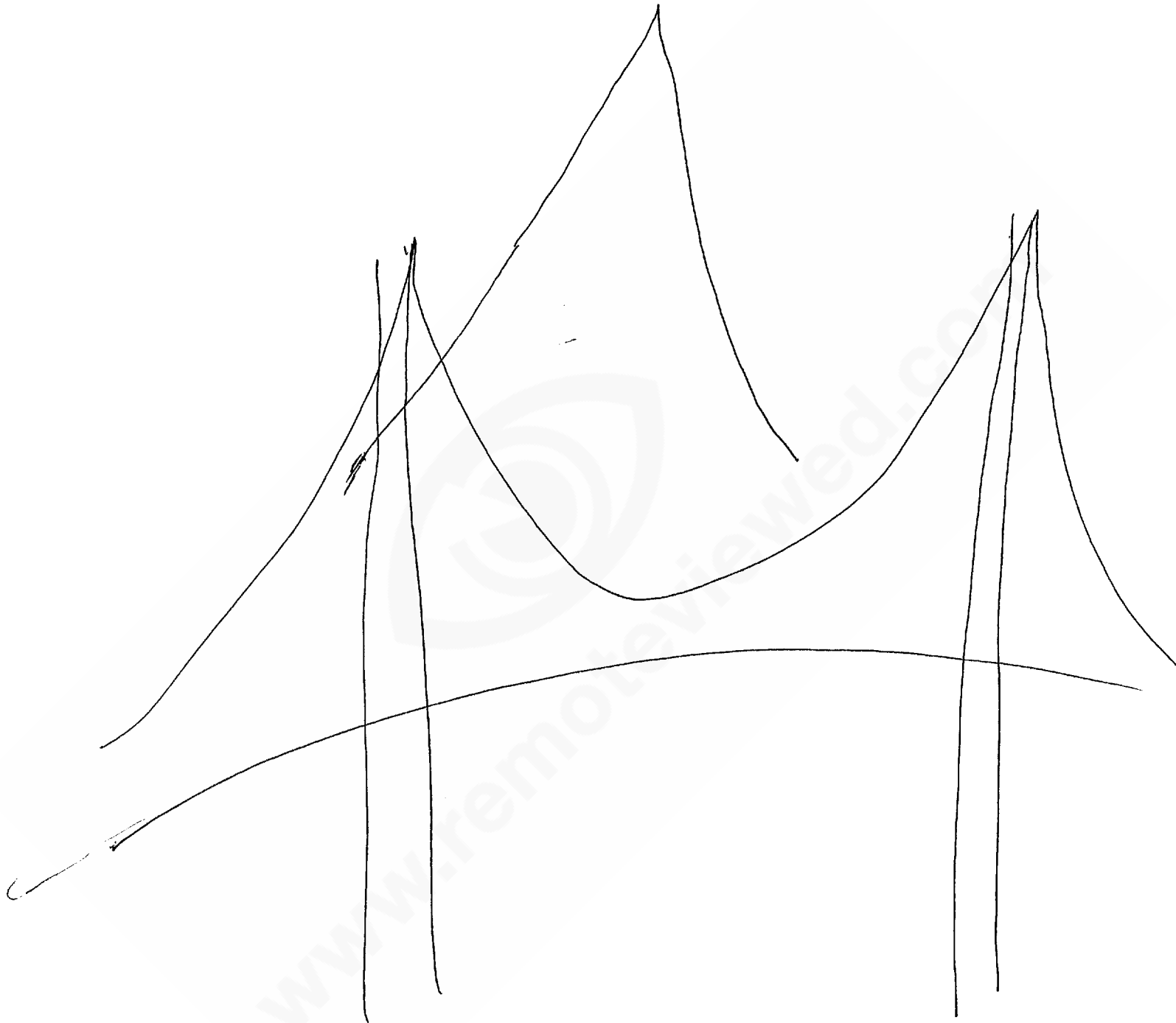

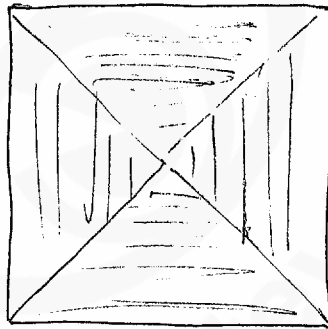

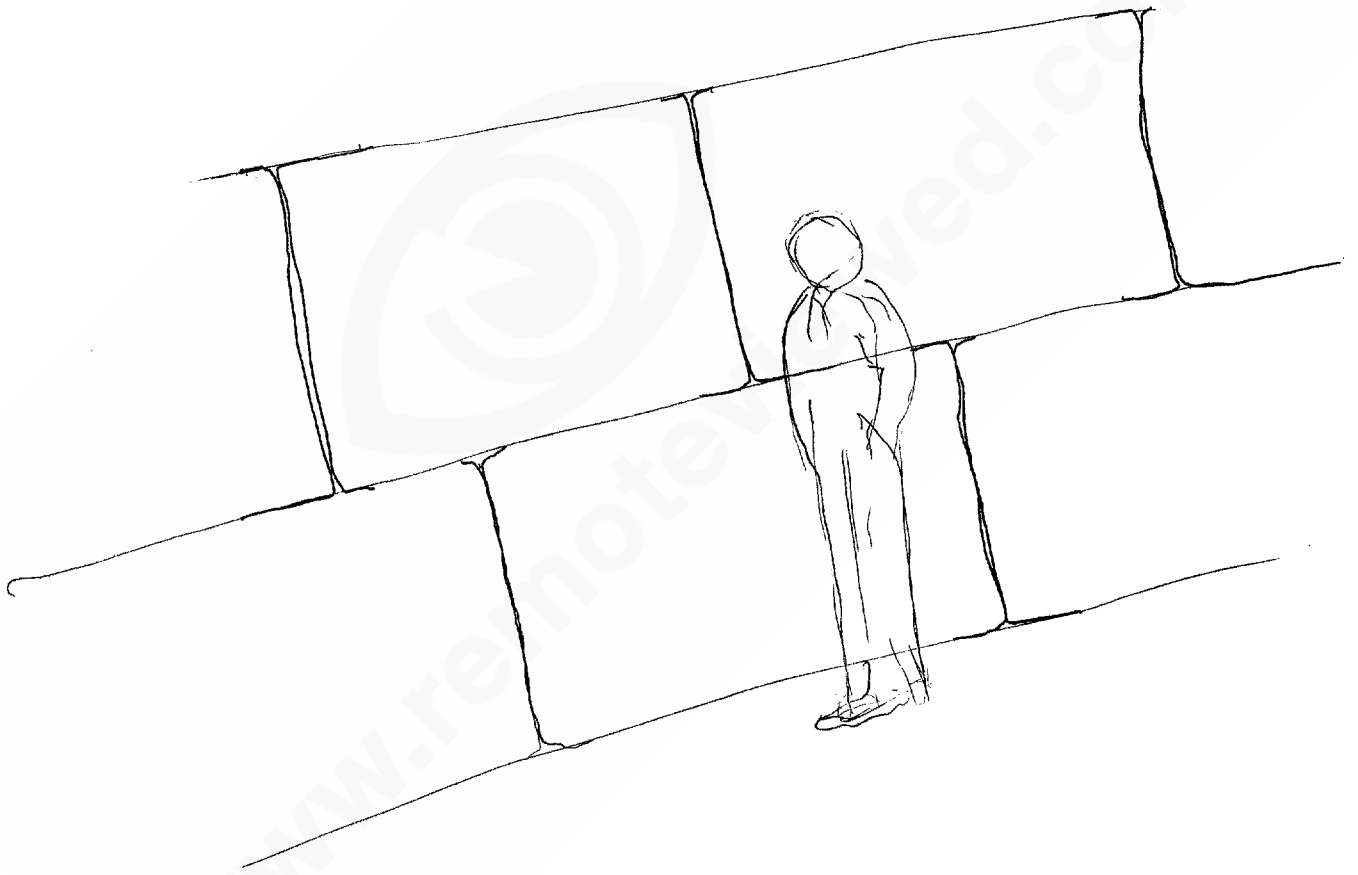

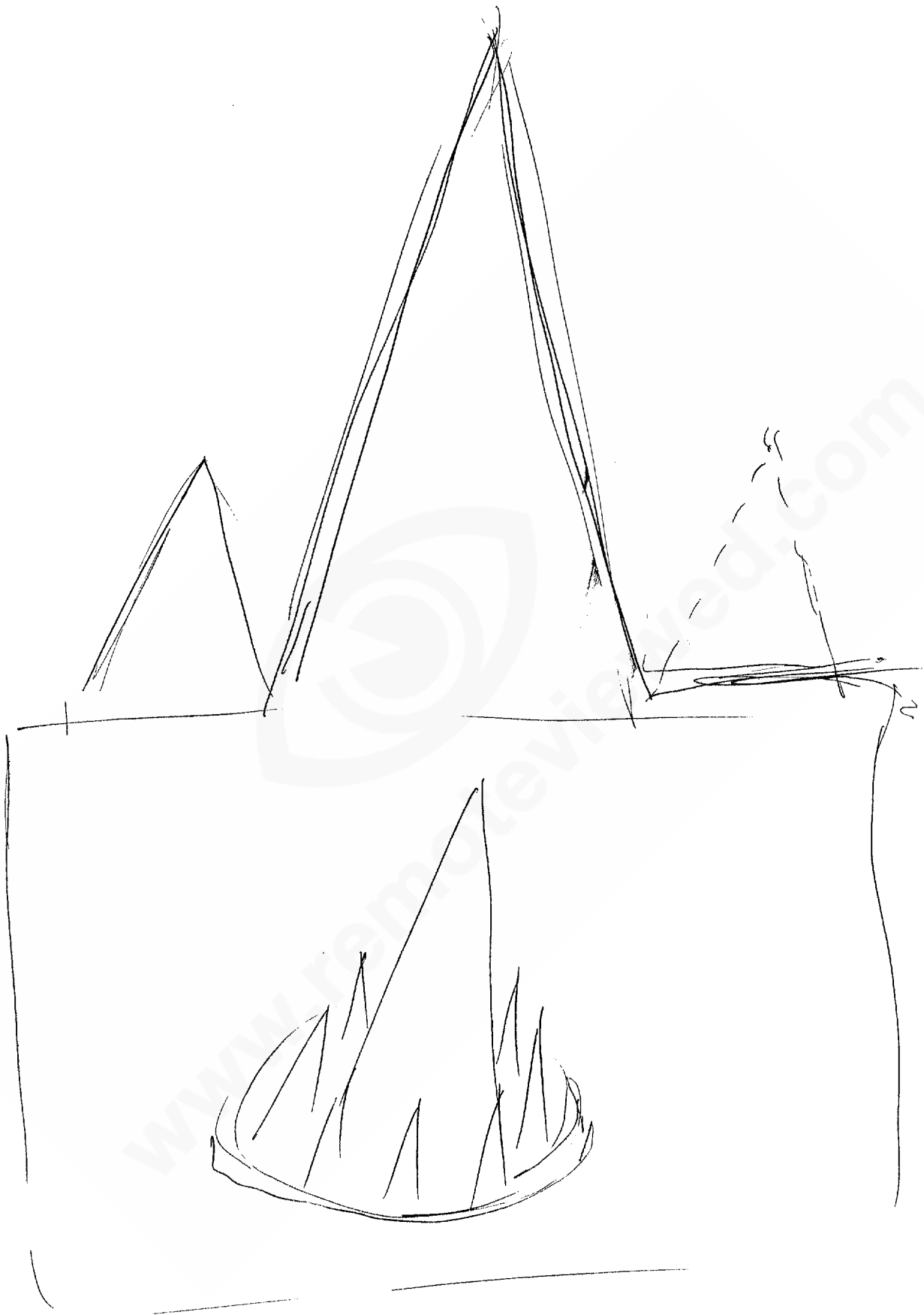

SZ

ROC/AS

[SITE]

TAN
RALF
ROBERT
COLD
PARCE
SOLD
HVE
HARD

Thick
dense
Hollow
180°
STARCH
CUBES
CURVE
Vertical
diagonal



ORNATE
Adams.
GOTHIC
Historic
significant
Important
ARTISTIC
singular
Solo
solitaire

*WOL Signal
Sketch*

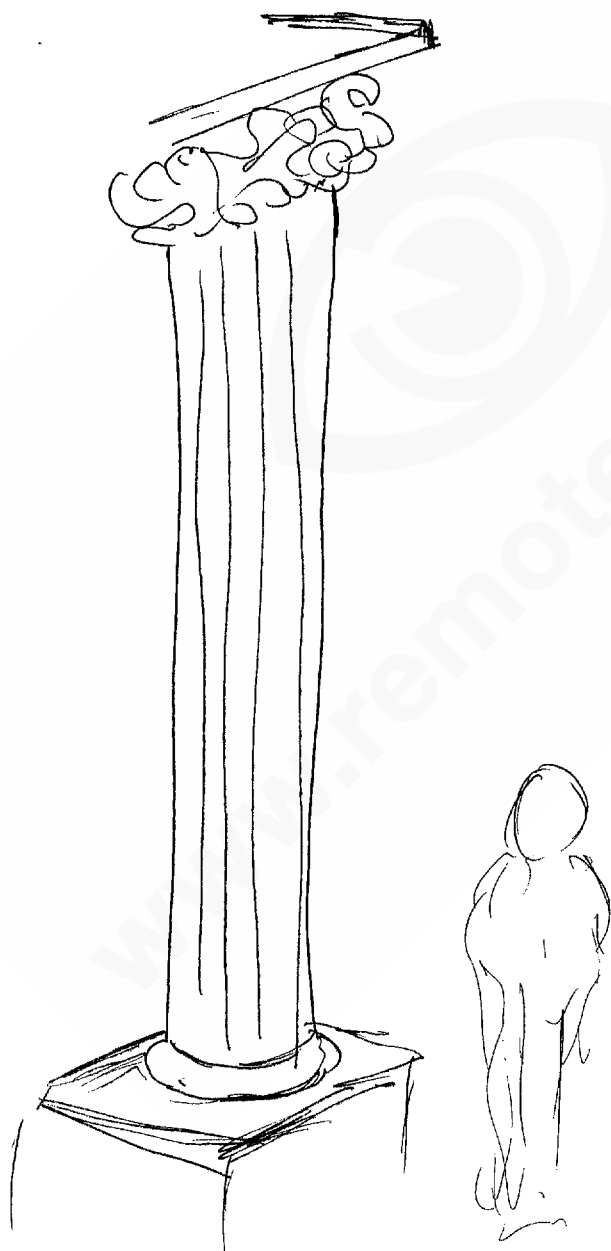

sh¹/₂ something art^{er} about it full narrow
portrayal of significant of somebody
or something - meant to preserve
the image, thought or idea
of person or event.



True line

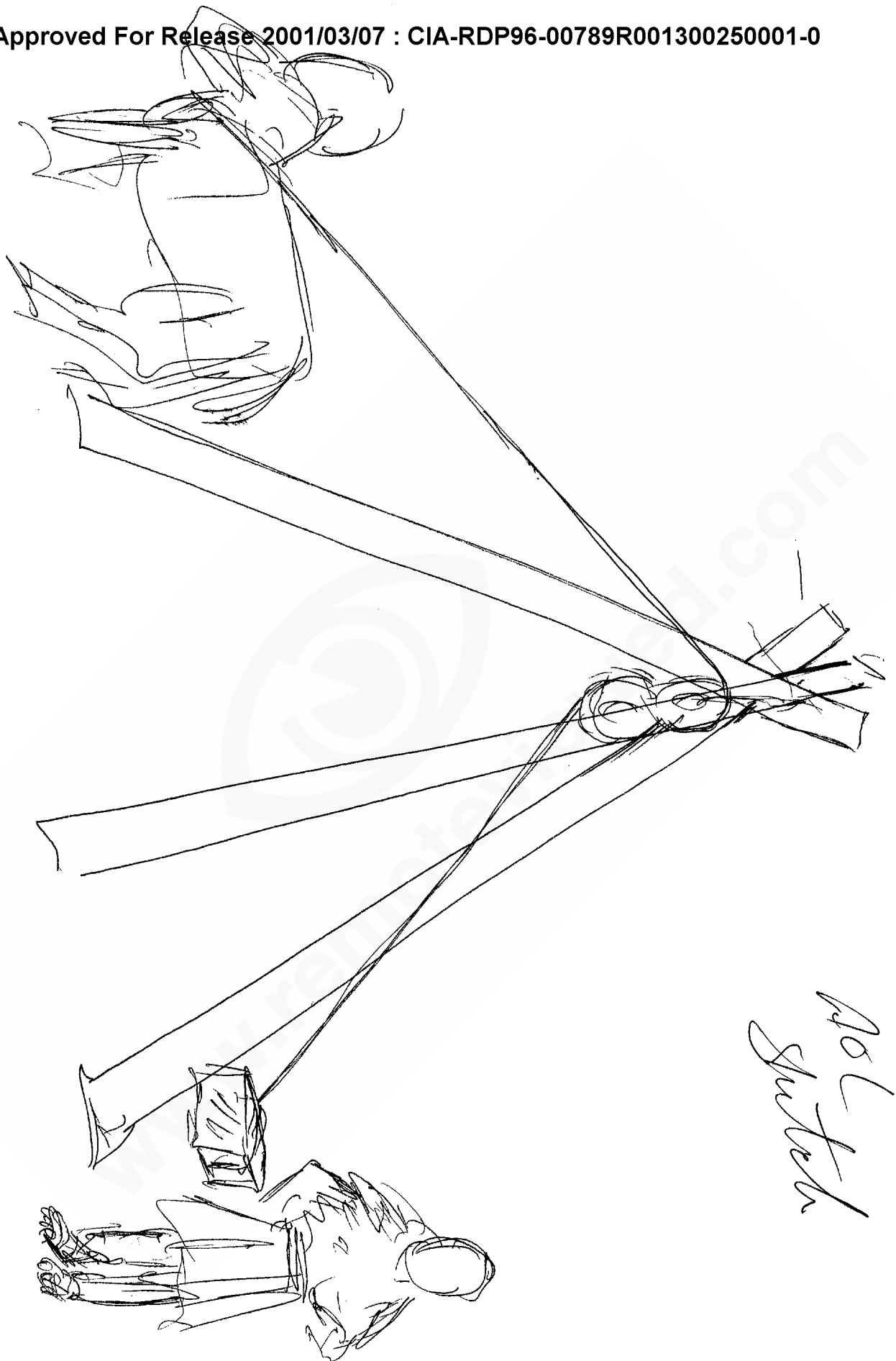

*As L
justed*

SZ D AI EI T I AOL/AS

WAR
COMBAT
CIVIL WAR - AOL

SH¹/₂ Blue & Gray - him of men
being each other over open
terrain - Trenches - rolling
hills - Ramparts - emblems
smoke, fire, haze - 1800-1900

AOL 300A
1800-1900

End
1/10

Is this some kind of war
memorial?

AOL SIGNAL
Switch

